

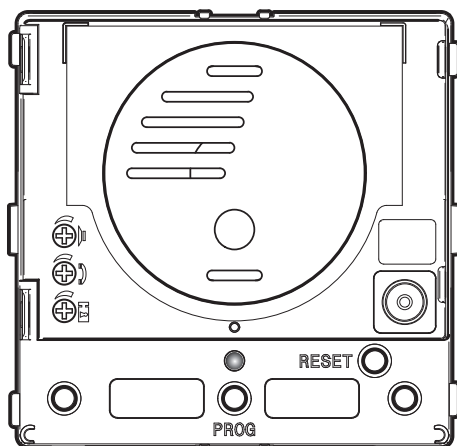

## Communication unit for X1 systems

FB00872-EN



# MTMAL/01

PROGRAMMING MANUAL

## General precautions

- Read the instructions carefully before beginning the installation and carry out the actions as specified by the manufacturer.
- The installation, programming, commissioning and maintenance of the product must only be carried out by qualified technicians, properly trained in compliance with the regulations in force, including health and safety measures and the disposal of packaging.
- Before carrying out any cleaning or maintenance operation, disconnect the device from the power supply.
- The equipment must be destined solely for the use for which it was expressly designed.
- The manufacturer declines all liability for any damage as a result of improper, incorrect or unreasonable use.

## REMOTE CONTROL OF CALL BUTTONS

### Manual configuration of terminals (•• and ⚡) as call inputs 1 and 2

Short circuit the terminals (•• and ⚡), press and hold the two call buttons on the unit, and power the device. The PROG LED flashes twice. The procedure has been completed successfully.

Remove the short circuit and connect the additional N.O. buttons to the terminals •• and ⚡.

## BUTTON NUMBERING

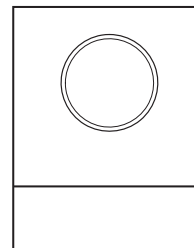
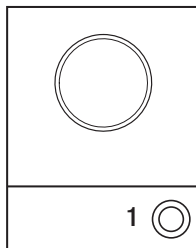
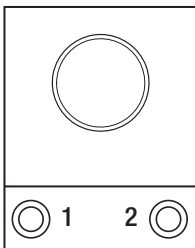
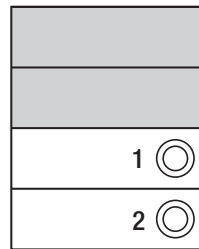
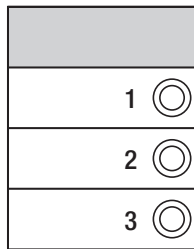
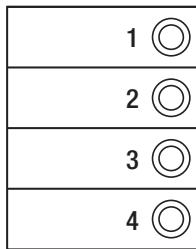
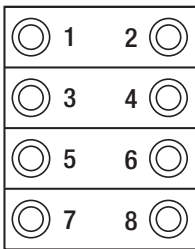

## Programming for the first time

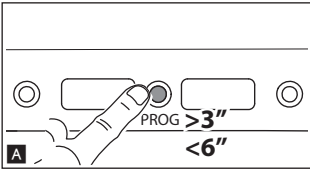

### Entering programming mode

Press the PROG button on the entry panel for at least 3 seconds **A** and release within 6 seconds.

The PROG LED on the entry panel flashes slowly and the buttons flash **B** to show the buttons are being programmed.

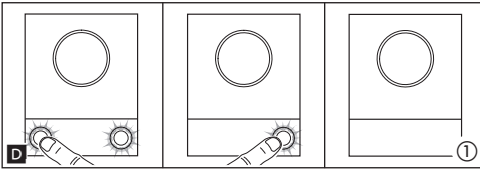
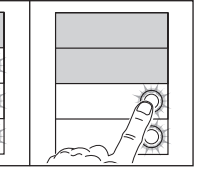
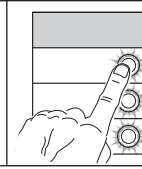
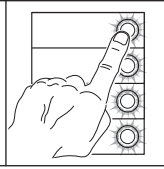
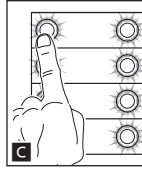
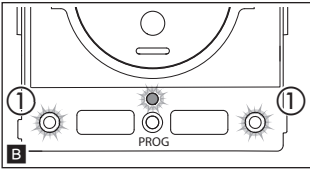

### Programming buttons

Press the first call button on each unit **C** or **D**. The unit stops flashing and remains on. Repeat for all the other call devices.

**NOTE. For the basic unit (no call buttons) **D** ①, you do not need to press the buttons that are shown as flashing in figure **B** ①.**

Once programming is complete, you are automatically taken to "programming calls".

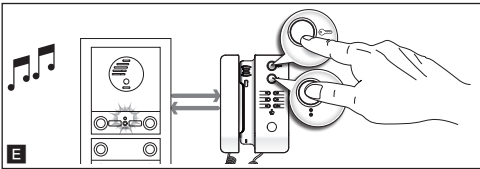

### Programming calls

The PROG LED on the entry panel flashes and a beep signals that you have entered programming mode. Lift the internal receiver handset (if present) and press the door lock release **—■** and AUX2 **●** buttons **E**. On the entry panel, press the call button to be linked to the internal receiver **F** ①. A beep confirms that the setting has been stored **F** ②. End the call and repeat for the other internal receivers.

**NOTE: You can force the switch from one programming mode to another by pressing the PROG button on the power supply unit for 3 seconds and releasing within 6 seconds. If you force the switch to call programming from button programming, the button units which have not been programmed are configured to 8 calls. If the base unit is not programmed, calls are not configured.**

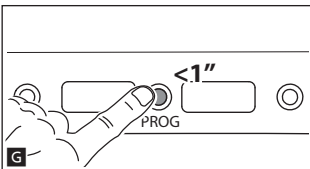
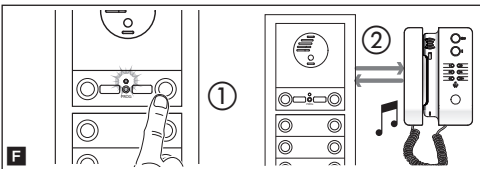

### Exiting Programming

Press the PROG button briefly **G**. The LED switches off.

## Reprogramming

Reprogramming a system which has already been programmed, you access the call programming phase directly. To access button reprogramming, follow the process for forcing the mode switch described above.

If you add, replace or remove an entry panel, you must follow the "programming buttons" procedure so that the system recognises the changes.

Programming for the first time

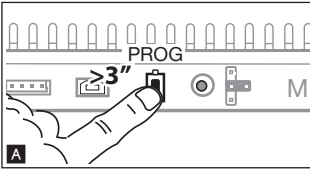

Entering programming mode

Press the PROG button on the power supply **A** until the PROG LED lights up. The PROG LED on the entry panel flashes slowly and the buttons flash **B** to show the buttons are being programmed.

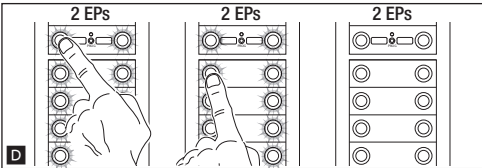
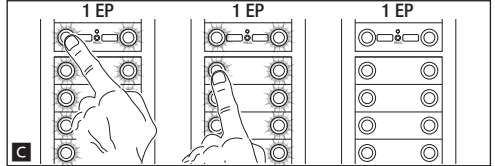
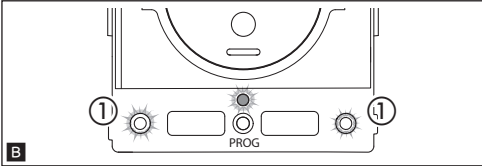

Programming buttons

Press the first call button on each unit **C D** (see the “call number” section). The LED lights on the unit remain on to show that the buttons have been programmed correctly.

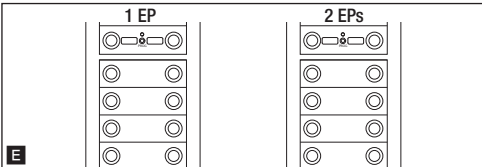

**NOTE. For the basic unit (no call buttons), you do not need to press the buttons that are shown as flashing in figure B ①.**

Repeat for all entry panels to be programmed. Once programming is complete, the configuration is implemented **E** and you are automatically taken to “programming calls”.

Programming calls

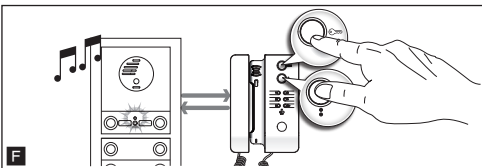

The PROG LED on the entry panel flashes and a beep sounds to signal that you have entered programming mode **F**. Lift the internal receiver handset (if present) and press the door lock release **1** and AUX2 **2** buttons **F**. On the entry panel, press the call button to be linked to the internal receiver **G ①**. A beep confirms that the setting has been stored **G ②**. End the call and repeat for the other internal receivers.

**NOTE. The operation can only be carried out from an entry panel with the beep active. To change the entry panel from which calls are programmed, press one of the call buttons on the entry panel you wish to use for programming.**

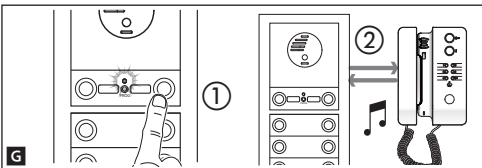

**NOTE. You can force the switch from one programming mode to another by pressing the PROG button on the power supply unit for 3 seconds and releasing within 6 seconds. If you force the switch to call programming from button programming, the button units which have not been programmed are configured to 8 calls. If the base unit is not programmed, calls are not configured.**

Exiting Programming

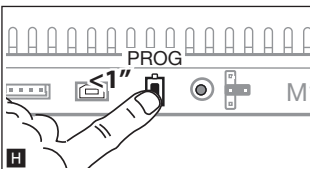

Press the PROG button on the power supply briefly **H**. The LED switches off and the entry panel stops ringing.

## Reprogramming

Reprogramming a system which has already been programmed, you access the call programming phase directly. To access button reprogramming, follow the process for forcing the mode switch described above.

If you add, replace or remove an entry panel, you must follow the “programming buttons” procedure so that the system recognises the changes.

### RESTORE FACTORY DEFAULT

To restore the entry panel to the default settings (including the terminal functions ●● and ) , remove the power supply, press and hold the two call buttons on the unit and power the device.

After 5 seconds the entry panel restarts.

**NOTE. If the entry panel does not restart, it has not been restored to default settings.**

This product complies with the relevant directives in force.

**Decommissioning and disposal.** Dispose of the packaging and the device at the end of its life cycle responsibly, in compliance with the laws in force in the country where the product is used. The recyclable components are marked with a symbol and the material's ID marker.

THE DATA AND INFORMATION SHOWN IN THIS MANUAL ARE TO BE CONSIDERED AS SUBJECT TO CHANGE AT ANY TIME AND WITHOUT THE NEED FOR ANY ADVANCE WARNING.

MEASUREMENTS, UNLESS OTHERWISE INDICATED, ARE IN MILLIMETRES.





**CAME**   
**BPT**

[CAME.COM](http://CAME.COM)

**CAME S.P.A.**

Via Martiri Della Libertà, 15  
31030 Dosson di Casier - Treviso - Italy  
tel. (+39) 0422 4940 - fax. (+39) 0422 4941