

* ALWAYS TEST THE UNIT ON SITE BEFORE INSTALLATION TO AVOID RE-STOCKING FEE * See full T&C's on our website

e-Trans 200 Connection Diagram

Technical Specs:

Voltage: 10-36V ACDC.
Current draw standby: Radio Awake state 16 m/a – Radio Sleep state 4.5 m/a.
Frequency: 433.39 MHz.
Remote storage: 200 remotes / 4 x e-Loops / 4 x Keypads / 4 x Entry Buttons.
Remote storage allocation: Each remote can be set to a unit number ID.
Relay: 1-amp contact rating, COM and N/O connections x 2 relays (Pulse, Latch and Hold modes).
e-Loop: Connect direct to e-Loop to alter settings.
Lock out function: Ability to lock certain coded devices by remote 1.

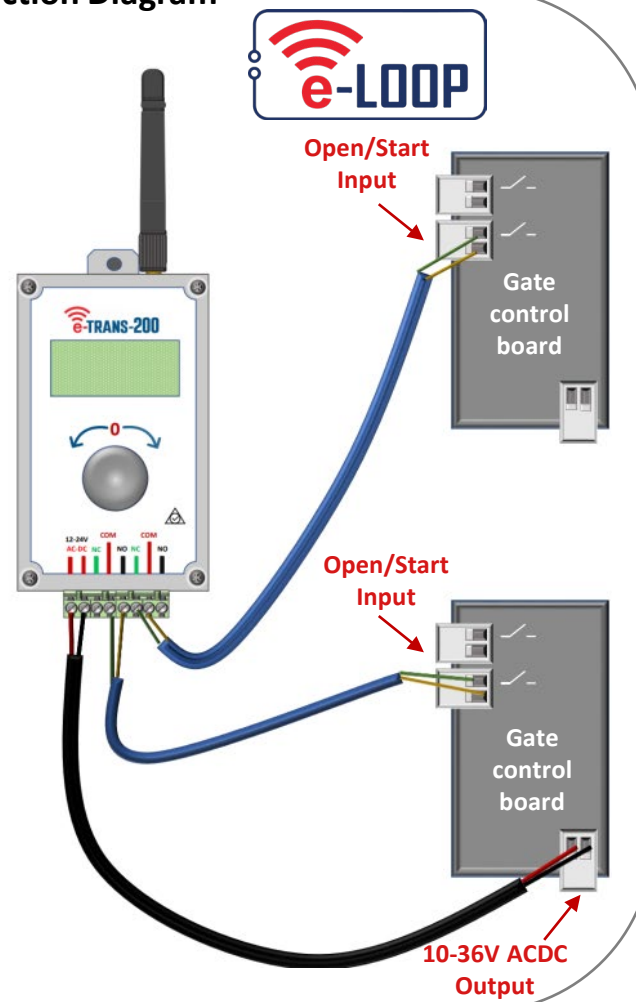
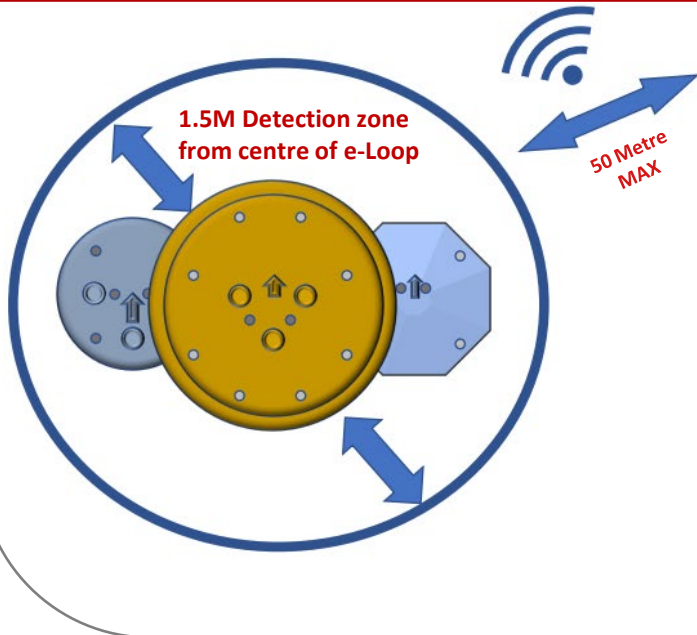

Coding devices:

To code e-TX/remote device: Rotate dial clockwise to CODE DEVICE then press PB dial. CODE LEARN will display and green LED will flash indicating coding sequence. Press e-TX/remote button once > display will show ACCEPT REM 1, then screen will display CONFIRM REM 1, press e-TX/remote button one final time and screen will display REM 1 CODED.



To code e-Loop– Method 1: Rotate dial to CODE DEVICE then hold e-Loop next to the Transceiver antenna. Now press PB dial and release. Display will show E-LOOP CODED. CODE DEVICE will exit and return to main screen.



To code e-Loop–Method 2: Rotate dial to CODE DEVICE then press PB dial, CODE LEARN will be displayed. Now press and release e-Loop CODE button. Screen will display E-LOOP CODED and will exit back to main screen,(for commercial e-Loop, use the magnet provided to activate the CODE button)



YouTube



Full Manual



Ensure e-Trans is not in a steel/metal enclosure which can reduce signal range.
The transceiver should be mounted as high as possible with clear line of sight to loop to maximise range.

Check out our YouTube channel for how to guides



EXTRA RESOURCES

NEED MORE ASSISTANCE?

+44 (0)288 639 0693

SCAN THIS QR CODE TO BE BROUGHT TO OUR RESOURCES PAGE.

VIDEOS | HOW-TO GUIDES | MANUALS | QUICK START GUIDES

*** ALWAYS TEST THE UNIT ON SITE BEFORE INSTALLATION *** See full T&C's on our website

FAQ'S

Question	Answer
Q: My loop will not code to transceiver?	A: Ensure loop is held directly beside transceiver for pairing process, initiate code process on transceiver, this should automatically detect loop and successfully pair if close enough. For commercial or inground loops: these can be paired in close proximity or further away in location by using pairing method 2. See full manual for instructions.
Q: What is the max distance between loop & transceiver?	A: The loop can be placed up to 50M away from the transceiver using supplied antenna, ensure a clear line of sight between loop & transceiver. Please note: housing the transceiver in a metal enclosure or close to high voltage power lines could reduce the transmission range. If you are having issues, please try house the transceiver in its own separate enclosure or try an external antenna.
Q: Can I change the sensitivity of the loop?	A: The loop has a detection area of 1.5M (radial) distance from the centre of loop. By default, our loops are setup in a way that they will detect almost any vehicle as it passes directly over the loop. If you feel the loop is too sensitive and picking up smaller objects other than vehicles it may be worth trying to recalibrate the loop firstly. Please refer to full manual on how to do so with the e-Trans 200. If still having issues, please call technical support to discuss. +44 28 8639 0693
Q: I have paired the loop, but it is not triggering gate/barrier?	A: Test by placing metal object or driving vehicle over loop, on the transceiver check if Red/RX LED comes on while doing so, this will indicate the loop is triggering and signal sent to transceiver firstly. If gate is not triggering, double check wiring from gate motor, you can also test & prove relay is changing state by using a multi-meter. If still having issues, please call technical support to discuss further. +44 28 8639 0693
Q: Can I pair multiple loops to 1x transceiver?	A: Yes, you can pair up to 4x loops to either e-Trans 50 or e-Trans 200. This can be any variety of loops; exit mode, presence mode, commercial or residential.



AES Global Ltd - 4 Kilcronagh Business Park, Cookstown, BT80 9HJ, UK.

Product Type: Wireless Vehicle Detection & Automation.

Hereby, AES GLOBAL LTD declares that the radio equipment type E-TRANS-50 is in compliance with Directive 2014/53/EU. The full text of the EU Declaration of Conformity is available at the following internet address:

www.aesglobalonline.com/e-loop#ce



This product is not a complete product until fully installed. It is therefore considered a component part of an overall system. The installer is responsible to check that the end installation complies with local regulatory requirements. This equipment forms part of a "fixed installation".

STILL HAVING TROUBLE?

Find all of our support options such as Web Chat, Full Manuals, Customer Helpline and more on our website:

WWW.AESGLOBALONLINE.COM

+44 (0)288 639 0693