

4.2 PREPARING THE COLUMN

i The dimensions, hole positions and the door opening of the column must be correct. The dimensions shown refer to the internal dimensions of the column. If the rack has already been mounted, follow the installation specifications (§ 5.3).

INSTALLATION WITH ENCLOSURE MOUNTING BRACKET

A

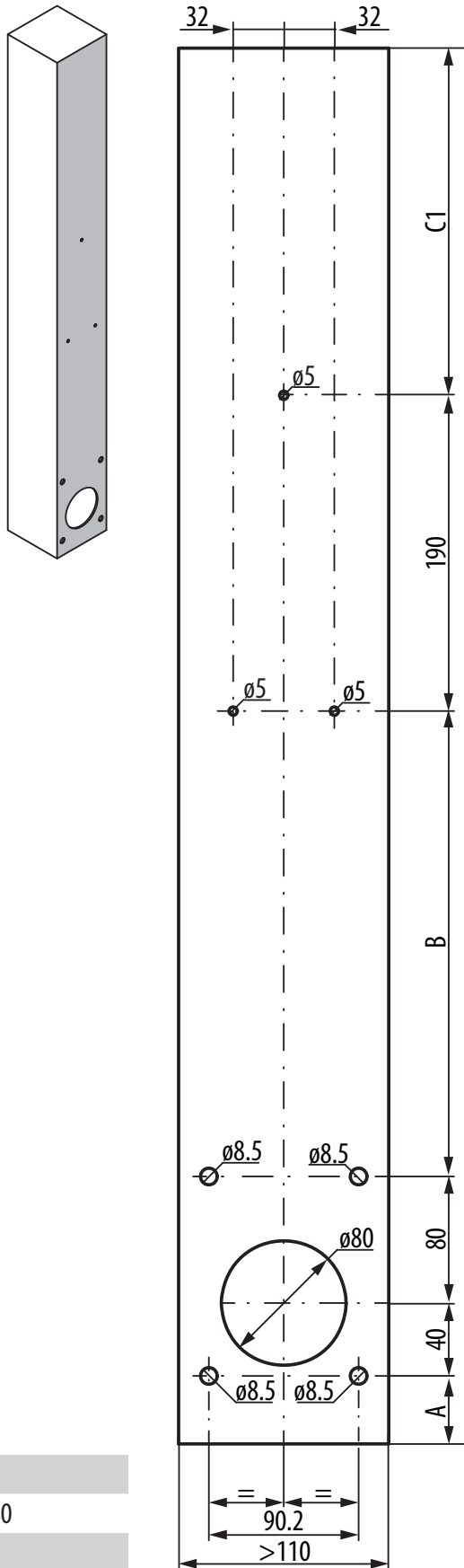

- A > 30
- B 180 ... 280
- C1 > 200

INSTALLATION WITHOUT ENCLOSURE MOUNTING BRACKET

B

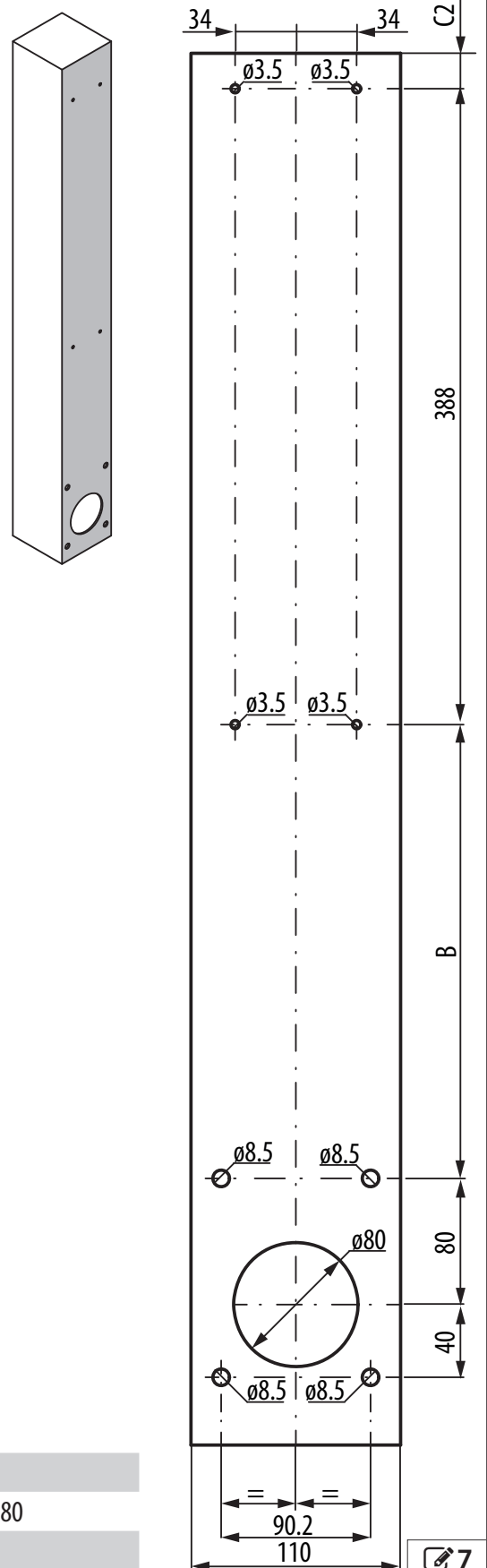

- A > 30
- B 180 ... 280
- C2 > 10



DOOR OPENING MEASUREMENTS

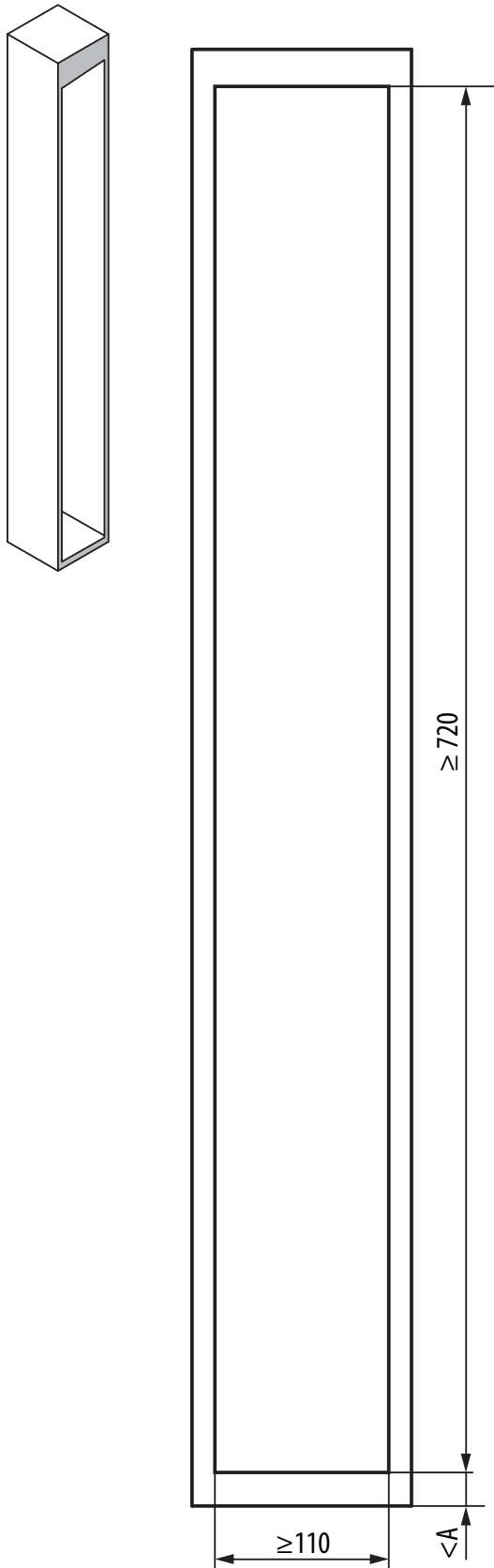

8

GATE RELEASE SLOT POSITION

The gate release slot can be on either side of the column.

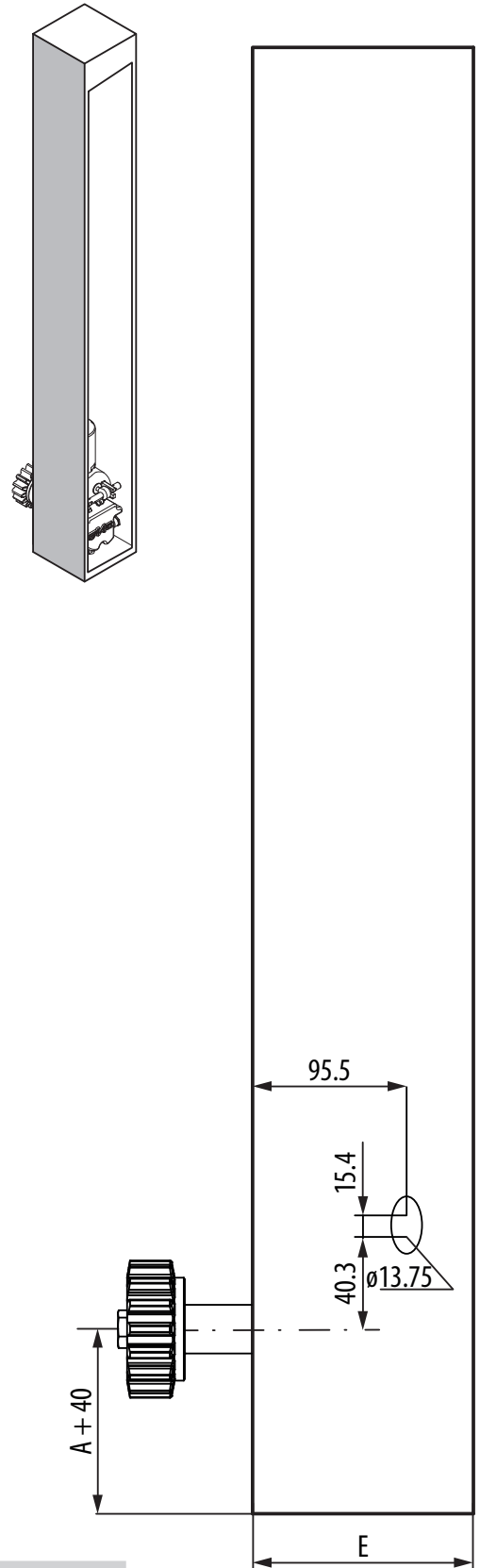

E ≥ 113 6-A

E ≥ 110 6-B

9